

# HCL Commerce CMS-DAM Demo – SoFy Environment

## Step 1 – Review Current Website

1. Open EmeraldPlus storefront link from the SoFy Solution Console link
2. Review current home page banner
  - a. We will be replacing the video banner with a static banner using the CMS and DAM add-on

## Step 2 – Create New Content

1. Open Authoring Management Center from the SoFy Solution Console link
  - a. Login using the credentials wcsadmin | wcs1admin
2. Menu > Workspace Management > File > Work on Approved Content

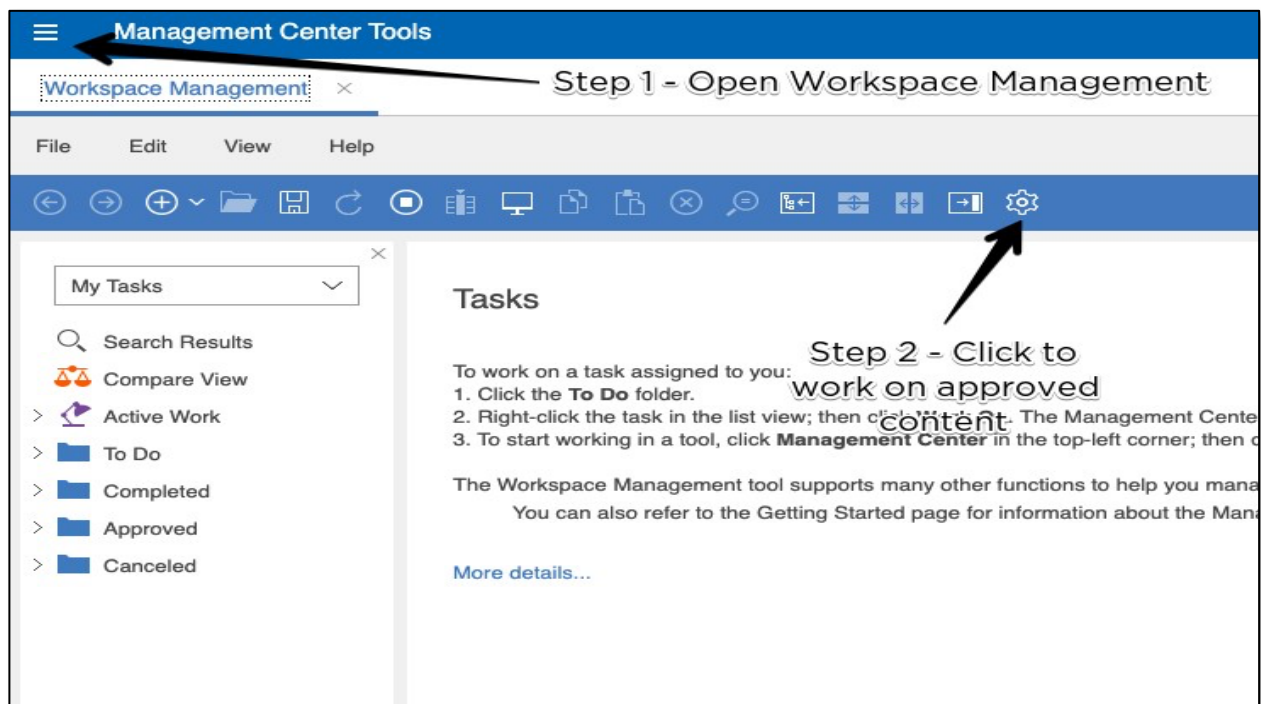

3. Open up CMS-DAM tooling by going to Menu > Content
  - a. Login using credentials wpsadmin | wpsadmin
4. Click on the Home icon on the top right of the page and select "Home"
5. Click on Digital Assets section
6. Click on the EmeraldPlusSAS collection
  - a. Review items in the collection
  - b. Click on Collections link to go back
7. Click on EmeraldCAS collection
  - a. Review items in the collection
  - b. Enter "Chair" in search box and click enter
  - c. Click on dropdown in search box to show other search options
  - d. Click on Filter button to review filter options
  - e. Click Back link and the Collections link to go back to main DAM area
8. Click on EmeraldPlusSAS collection

- a. Click on livingroom.jpg
  - b. Click on three-button link in the information area and select Edit
  - c. Review the different versions and options available for the asset
  - d. Click cancel and discard changes to exit the page
9. Click on hamburger menu in top left and select Web Content
10. From the Commerce Composer section navigate to Commerce Marketing Content > Content > EmeraldPlus
11. Click on HomeHeroVideoBanner and click Edit
- a. Review the content details
  - b. Click on versions to see the available versions of the content
  - c. Click Cancel to leave the page
12. Select Create > Content from the top of the page
- a. Use the following details for the content properties
    - i. **Name:** NewHomeHero
    - ii. **Display Title:** NewHomeHero
    - iii. **Description:** New Home Hero Image
    - iv. **Select Content Template**
      1. Click on See All Content Templates
      2. Navigate to Commerce Marketing Content > Marketing Content and click Select
  - b. In the elements area, complete the following
    - i. **Image**
      1. Click on the dropdown and select HCL DAM
      2. Click Select Image
      3. From the assets go to EmeraldPlusSAS > emerald-home-hero.jpg and click Insert
    - ii. **Use as Background Image**
      1. Click on radio button: Use as background image

### Test (Rich Text)

1. Paste in the following text:

## Explore Dozens of New Arrivals

Freshen up your living space with all new furniture, lighting, and decor that fit any living room style.

2. Modify the text to change the headline to read "Take a Look at all of the New Arrivals"
- iv. **Button Link:** /living-room
- v. **Button Text to Display:** Shop Living Room
- vi. **Button Appearance:** Primary Button
- vii. Click Save
- c. Click Cancel and verify that NewHomeHero is listed in the available content items

### Step 3 – Add Content in Management Center

1. If page isn't already open, click Authoring Management Center from the SoFy Solution Console link
  - a. Login using the credentials wcsadmin | wcs1admin

- b. Verify that you are still working on approved content
2. Menu > Marketing
3. Change storefront to EmeraldPlus if not already selected
4. From left side menu, click Content
  - a. Review content pieces that are present
5. Right click on Content > New Content
  - a. **Name:** NewHomeHero
  - b. **Content Type:** Digital Experience Content
  - c. **Content Item**
    - i. Click on Edit icon
    - ii. Navigate to Commerce Marketing Content > EmeraldPlus > NewHomeHero and click Select
  - d. Click on Save and Close
6. From left side menu select E-Marketing Spots
  - a. Click on Home Hero entry to open details
  - b. Go to Default Content section
    - i. Enter New\* in the search box
    - ii. Change Find and Add dropdown box to select Content
    - iii. Click Find and Add button
    - iv. Select the HomeHeroVideoBanner item and click on the X button to remove it c.
  - Click on Save and Close

#### Step 4 – Review Changes on Home Page

1. If page isn't already open, click on the EmeraldPlus storefront link from the SoFy Solution Console link
2. Refresh the EmeraldPlus storefront home page
  - a. Verify that new content is showing
3. Return to Management Center
  - a. If page isn't already open, click Authoring Management Center from the SoFy Solution Console link
  - b. Login using the credentials wcsadmin | wcs1admin
4. Open up CMS-DAM tooling by going to Menu > Content
  - a. Login in using credentials wpsadmin | wpsadmin if required
  - b. Click on the Home icon on the top right of the page and select "Home"
  - c. Select the Web Content section
  - d. Navigate to Commerce Marketing Content > Content > EmeraldPlus > NewHomeHeroContent and click edit
5. Scroll down to the banner text area and update the content
  - a. Change headline size to 36 and text section to size 22
  - b. Change color to gray for all the text
6. Click Save
7. Return to EmeraldPlus storefront
  - a. If page isn't already open, click on the EmeraldPlus storefront link from the SoFy Solution Console link
8. Refresh the storefront Home Page

## Step 5 – Review Content Using APIs

1. Open Postman
2. Import Environment JSON into the workspace
  - a. Select Environments > Import
  - b. Click “Upload Files” and select the “HCL Commerce SoFy CMS-DAM Demo - Environment.json” or drag file into the window
  - c. Click Import

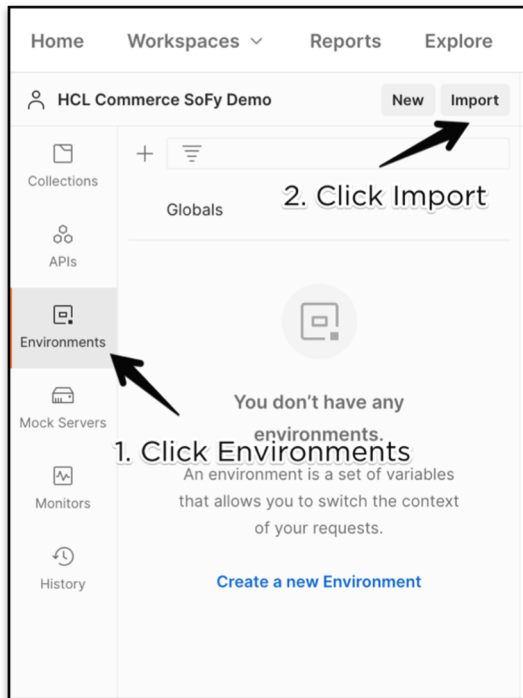

3. Update “hostname” variable
  - a. Click on “HCL Commerce SoFy CMS-DAM Demo”
  - b. Update the current value of “hostname” by replacing the astrisk values with the number shown on your SoFy Solutions Console
  - c. Click Save
4. Import API Collection into the workspace
  - a. Select Collections > Import
  - b. Click “Upload Files” and select the “HCL Commerce SoFy CMS-DAM Demo - API Collection.json” or drag file into the window
  - c. Click Import
5. Run API Collection
  - a. From the collections area, click “HCL Commerce SoFy CMS-DAM Demo” to expand APIs
  - b. Click on “Get eSpot Details” API
  - c. On the right side, click on “No Environment” and select “HCL Commerce SoFy CMS-DAM Demo” from the dropdown menu
  - d. Run API by clicking “Send”
    - i. Verify return details look correct by confirming line 14 says “eSpot Name: Home Hero”
    - ii. Confirm contentType information is shown in line 24

- e. Click on “Get Marketing Content Details” API and click Send
  - i. Scroll to line 324 and verify values are the same as what was updated in the CMS